



**CHERRYBROOK  
TECHNOLOGY HIGH  
SCHOOL**

**Year 6 into 7  
Information Night  
2023**

Tuesday 7 March 2023  
5.30pm-7.30pm

## PROGRAM

5.30pm - 6.10pm	
Welcome and Overview of Evening	<i>Harry Jackson and Umica Ratnam, School Captains</i>
Principal's Address <ul style="list-style-type: none"> <li>❖ Comprehensive Technology High School</li> <li>❖ Academic</li> <li>❖ Curriculum</li> <li>❖ Creative &amp; Performing Arts</li> <li>❖ Sport</li> <li>❖ Wellbeing</li> <li>❖ Multicultural &amp; International</li> </ul>	<i>Gary Johnson</i>
Role of Stage 4 Head Teacher & Student Advisers <ul style="list-style-type: none"> <li>❖ Enrolment Procedures</li> </ul>	<i>Rebecca Howard</i>
Student Wellbeing <ul style="list-style-type: none"> <li>❖ Year 7 First Impressions</li> </ul>	<i>Alison Gatt</i>  <i>Year 7 students</i>
Question and Answer Forum	<i>Gary Johnson &amp; Panel</i>
6.10pm - 7.30pm	
Tour of School	<i>Student Leaders</i>
7.30pm	
Supper in the Piazza	<i>Hospitality students</i>
7.45pm	
Information about the 7T High Potential and Gifted Education class, MPC	<i>Gary Johnson &amp; Rebecca Howard</i>

## Contents

Why Cherrybrook Technology High School? .....	5
Academic Success .....	5
Curriculum Choice .....	6
Sporting Opportunities.....	6
Cultural Opportunity .....	7
Student Wellbeing, Leadership and Support .....	7
Enrolment Procedures for Year 7 2024.....	8
Local Area Enrolments - Proof of Residence .....	9
Rental Agreements.....	10
What happens if you move out of the local area? .....	10
Out-of-area Schools / Non-local Applications.....	10

# CTHS MAP

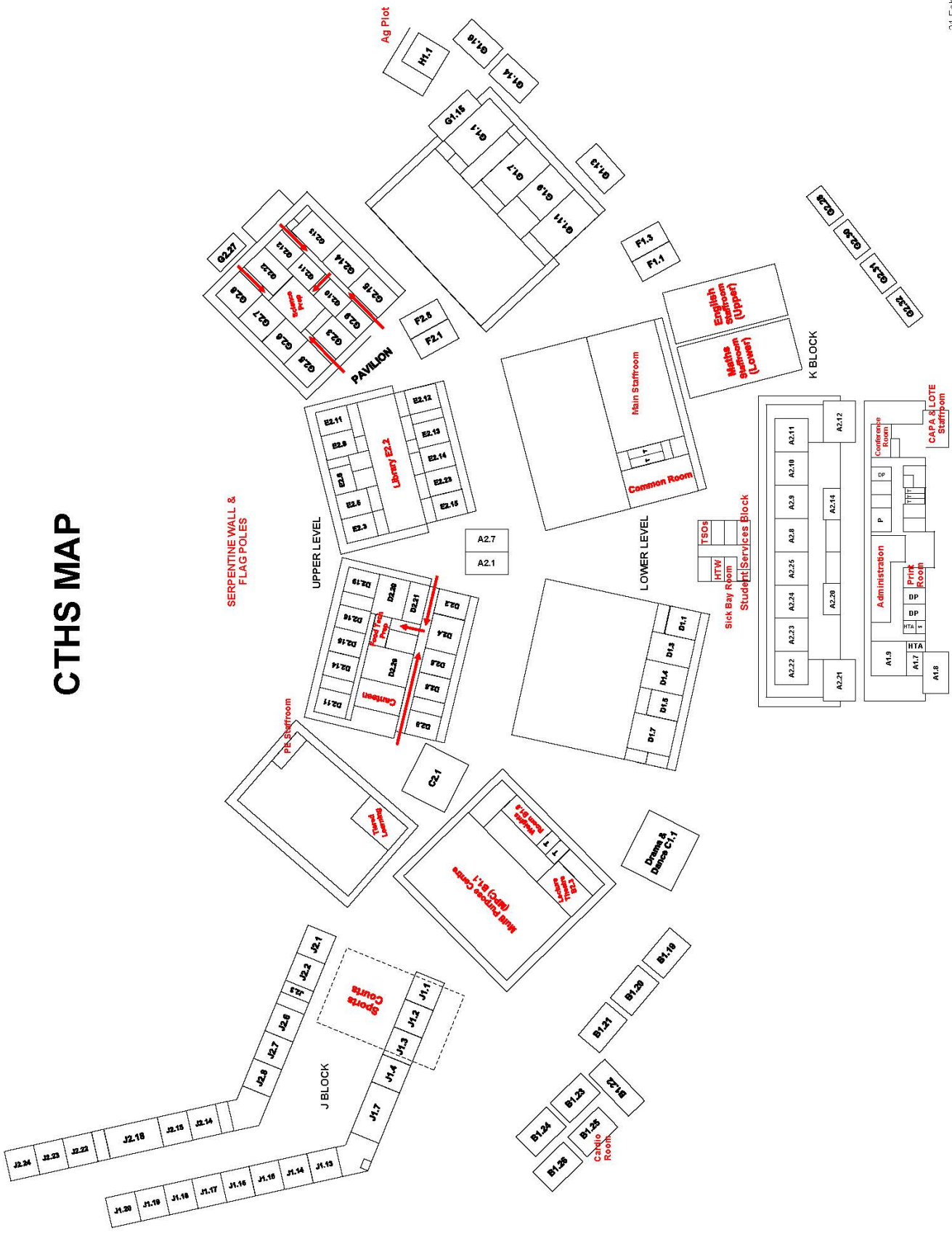

## Why Cherrybrook Technology High School?

Cherrybrook Technology High School is a truly comprehensive, coeducational Government technology high school, which aims to give all students the best opportunity to reach their potential in a caring, safe, technologically advanced environment. The facilities in the school are second to none, including a magnificent multi-purpose building which opened in 2018, a technologically equipped MPC (school hall), lecture theatre, power systems garage and drama rooms, which are the envy of many schools. A new STEM building is currently under construction and will be opening in 2024.

## Academic Success

Cherrybrook Technology High School has an outstanding tradition of academic success. In 2022 students achieved outstanding results in the HSC. These included:



- Sixteen students on the Premier's All Rounders list
- Six students with an ATAR greater than 99
- At least 98 students scored an ATAR greater than 90
- Five students who achieved a state placing in five separate courses of study
- 316 Band 6 results were achieved by 134 students in over 40 HSC courses.

Our Year 7 and 9 students also achieve results well above State and National average in the NAPLAN and Year 8 in Science VALID Tests.

Students in all years successfully participate annually in the Australian National competitions in a variety of subjects, with many of our students receiving distinction awards.



## Curriculum Choice

Cherrybrook Technology High School offers an extraordinarily extensive curriculum integrating advanced technology into all courses of study.

- Students in Years 7 and 8 follow a fixed curriculum, which includes English, Mathematics, Science, History, Geography, Technology, Personal Development, Health and Physical Education (PDHPE), Language (French, Chinese and Japanese), Music, Drama and Computing Skills
- Year 9 and 10 students study the core courses of English, Mathematics, Science, PDHPE, History and Geography, as well as a huge choice of elective courses, building toward the Record of School Achievement (RoSA)
- An enormous range of courses are offered in the senior school, including academic courses, such as Extension 2 in Mathematics and English, as well as vocational courses such as Hospitality and Building and Construction.



## Sporting Opportunities

CTHS sport features:



- A strong house system for our three important school Carnivals: Swimming, Cross Country and Athletics
- Many knockout teams catering for a huge variety of sports
- Gala Days for students in Years 7 and 8
- Grade sport played against other schools for students in Years 9 to 12, as well as a range of interest sports
- Student eligibility for Zone, Regional and State selection in over twenty sports.

In 2022, students achieved outstanding results in a variety of sporting activities including many impressive individual student achievements.



## Cultural Opportunity

Students are also actively encouraged to participate in debating and public speaking, areas of development which provide vital confidence to students for school and post school life.

CTHS has many different Music Ensembles including Bands, Choir, Guitar, String and Percussion. The school produces either a musical or a major drama production annually and encourages all students to participate in music, dance and drama activities.

Opportunities also exist for students to participate in a range of Visual Arts and Multimedia competitions.

Students in Years 9 to 12 may be able to participate in the International Study Tours to France or Japan. Students spend some time with a host family and are able to experience the culture first hand.



## Student Wellbeing, Leadership and Support

A transparent and comprehensive Wellbeing Scheme is one of CTHS's great strengths, providing a clear Awards Scheme, fair but firm consequences for inappropriate behaviour and a strong student support network, which incorporates programs for selected students in mathematics and literacy. Other features include a strong Peer Support Scheme and a Student Leadership Program, which includes a dynamic Student Representative Council (SRC).

These programs are supported by a Wellbeing Team, which is comprised of the Stage Head Teachers, Head Teacher Wellbeing, Head Teacher Student Programs, School Counsellors, Learning Support Teacher, Student Support Officer, Careers Advisers and Year Advisers for each grade and other interested parties, who meet on a regular basis to support students.



## Enrolment Procedures for Year 7 2024

Due by	Procedure
Monday 6 March 2023	<ul style="list-style-type: none"> <li>DoE primary schools issue parents or caregivers with the <b>Expression of Interest</b> hardcopy or link to digital <b>Expression of Interest</b> for placement in Year 7 at NSW Government Secondary School.</li> </ul>
Friday 24 March 2023	<ul style="list-style-type: none"> <li>DoE Year 6 students' parents or caregivers complete the <b>Expression of Interest for Placement in Year 7</b> form and return it to their child's primary school.</li> <li>Non-Government Year 6 students' parents or caregivers complete the <b>Expression of Interest for Placement in Year 7</b> form, downloaded via the following link and return it to CTHS. <a href="https://education.nsw.gov.au/public-schools/going-to-a-public-school/enrolment/high-school-enrolment">https://education.nsw.gov.au/public-schools/going-to-a-public-school/enrolment/high-school-enrolment</a></li> </ul>
Friday 19 May 2023	<ul style="list-style-type: none"> <li>CTHS Enrolment Committee meets and reviews all applications. The CTHS Enrolment Committee uses the criteria stated on the CTHS website for non-local enrolments.</li> </ul>
Friday 26 May 2023	<ul style="list-style-type: none"> <li>Successful and unsuccessful applicants will be notified by mail.</li> <li>Parents or caregivers of successful applicants will be sent an <b>Application to Enrol in a NSW Government School Form</b> and an application for the Year 7 High Potential and Gifted class.</li> </ul>
Friday 9 June 2023	<ul style="list-style-type: none"> <li>Parents or caregivers confirm enrolment at CTHS by returning their completed <b>Application to Enrol in a NSW Government School Form</b> and all required supporting documents.</li> </ul>
Friday 21 July 2023	<ul style="list-style-type: none"> <li>Students applying for the Year 7 HPGE class must also return the completed application, support material and payment.</li> </ul>
Saturday 5 August 2023	<ul style="list-style-type: none"> <li>Test for Year 7 HPGE class to be held at CTHS.</li> </ul>
Friday 1 September 2023	<ul style="list-style-type: none"> <li>CTHS Acceptance emailed to parents or caregivers confirming enrolment at CTHS.</li> </ul>
Friday 27 October 2023	<ul style="list-style-type: none"> <li>Students applying for the HPGE class will be notified of placement in this class.</li> </ul>
Friday 3 November 2023	<ul style="list-style-type: none"> <li>An Information Package will be sent to parents or caregivers about Orientation Day and Year 7 Camp</li> </ul>
Tuesday 28 November 2023	<ul style="list-style-type: none"> <li>Year 6 into 7 Orientation Day at CTHS from 9.00am to 11.00am. ALL students AND parents or caregivers are expected to attend.</li> </ul>



## Local Area Enrolments - Proof of Residence

A map showing the streets in our local drawing area can be found on the CTHS website:  
<https://cths.nsw.edu.au/>

When returning the **Application to Enrol in a NSW Government School** form you must submit documents, which confirm your home address within our drawing area. You will be required to provide documents which add up to a minimum of 100 points.

### Cherrybrook Technology High School

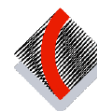

#### Enrolment Policy

#### 100 Points Residential Proof Checklist

##### Guidelines:

- All documents **MUST** be in the name of the enrolling parent / carer and show the child's address
- Applications must contain **ONE Category A** document
- All documents must be **current** (dated within the last three months).

Document	Points Value	Points Scored
<b>CATEGORY A</b>		
<ul style="list-style-type: none"> <li>• Contract of Purchase of Residential Property <b>OR</b></li> <li>• Property Lease Agreement (Registered and ongoing management by Real Estate Agent) of <b>MINIMUM twelve months duration</b> with signed Privacy Release form <b>OR</b></li> <li>• Council Rates Notice</li> </ul>	<p><b>50 points</b></p> <p><b>[SELECT ONE ONLY]</b></p>	<input type="checkbox"/>
<ul style="list-style-type: none"> <li>• Property Lease Agreement (Registered and ongoing management by Real Estate Agent) of six months duration with signed Privacy Release form, <b>with the school to review continued enrolment by the Principal</b></li> </ul>	<b>30 points</b>	<input type="checkbox"/>
<ul style="list-style-type: none"> <li>• Private Lease Agreement of twelve months duration</li> </ul>	<b>10 points</b>	<input type="checkbox"/>
<b>CATEGORY B</b>		
<ul style="list-style-type: none"> <li>• Electricity <b>OR</b> Gas Bill showing <b>current tariff</b> usage</li> </ul>	<b>20 points</b>	<input type="checkbox"/>
<ul style="list-style-type: none"> <li>• Electricity Connection Notice</li> </ul>	<b>5 points</b>	<input type="checkbox"/>
<b>CATEGORY C: Only ONE of each type of document is accepted</b>		
<ul style="list-style-type: none"> <li>• Water Bill (Excludes Water bill paid via real estate agency account)</li> <li>• Telephone <b>OR</b> Mobile phone bill</li> <li>• Internet provider bill</li> <li>• Australian Tax Office assessment / PAYG instalment notice</li> <li>• Australian Electoral Roll Confirmation letter</li> <li>• Bank Statement</li> <li>• Superannuation Statement</li> <li>• Home Building <b>OR</b> Home Contents Insurance policy</li> <li>• Motor Vehicle registration <b>OR</b> Motor Vehicle Insurance policy</li> <li>• Health <b>OR</b> Life Insurance policy</li> <li>• Proof of Employment / Payslip with address *                      (*Self-employed payslip not accepted)</li> <li>• Centrelink payment statement</li> </ul>	<p><b>10 points</b></p> <p><b>[EACH]</b></p>	<input type="checkbox"/>

## Rental Agreements

If your rental agreement expires during 2024 you will be required to resubmit a current lease agreement.

## What happens if you move out of the local area?

Local area enrolments who move out of the area **will have to write to the Principal requesting a review of their enrolment.** This will be assessed by the CTHS Enrolments Committee and may result in a reversal of the original decision to accept your child at CTHS. In this situation, your child may have to leave this school and enrol at their local high school.

## Out-of-area Schools / Non-local Applications

Parents may apply to enrol their child at CTHS if they live outside the enrolment area. A map of the drawing area can be found on the CTHS website and in this booklet.

<https://cths.nsw.edu.au/>

Non-local applications will be considered by the CTHS Enrolment Committee, according to the DoE policy and the school procedures. The CTHS Enrolment Committee will review each application on its own merits and will only consider information included in the supporting documents provided to the school. In some circumstances the Enrolment Panel may request additional documentation to support enrolment applications.

If you live outside the local enrolment area, you must complete Part C of the ***Expression of Interest for Placement in Year 7*** form. You may also wish to attach additional supporting documents.

It is important to note that giving false or misleading information is a serious offence. In the event that statements made in your application later prove to be false or misleading, any decision made as a result of the application may be reversed.

If you are dissatisfied with the outcome and feel you have not been treated fairly or the result is unreasonable, you may lodge an appeal. The appeal should be made in writing to the Principal.

# CHERRYBROOK TECHNOLOGY HIGH SCHOOL LIST OF STREETS IN CATCHMENT AREA

- A** ABELIA CLOSE  
ACER COURT  
ALICE COURT  
ALLARA PLACE  
ANNE PLACE  
AMBERLEA COURT  
APPLE TREE DRIVE  
ARMIDALE CRES  
ARUNDEL WAY  
ASH STREET  
ASHFORD ROAD  
ATHELLA PLACE
- B** BARCOTE PLACE  
BARKLEY CLOSE  
BASSETT PLACE  
BAYDON STREET  
BEECHWOOD PARADE  
BELL TREE CR  
BELLWOOD PLACE  
BERNARD PLACE  
BEVERLY PLACE  
BLACKWATTLE PLACE  
BLAMEY WAY  
BOLDREWOOD PLACE  
BOOTH PLACE  
Part of BOUNDARY ROAD  
(Nos 220-222)  
BOWEN CLOSE  
BOXWOOD PLACE  
BRAEMORE COURT  
BROADOAK PLACE  
BROKENWOOD PLACE  
BROSAN PLACE  
BRUNEL CLOSE  
BRUNSBOX PLACE  
BURRAWANG STREET
- C** CABER CLOSE  
CAMELIA COURT  
CANNAN CLOSE  
CAPE PLACE  
CARINA PLACE  
CARMEN CRESCENT  
CAROB PLACE  
CASTLE LEA COURT  
Part of CASTLE HILL ROAD  
(Nos 210-214)  
CAVERSHAM COURT  
CHADLEY COURT  
CHARLES PLACE  
CHATHAM COURT  
CHERRYHAVEN WAY  
CHILDREY PLACE  
CHISWICK PLACE  
CLAREMOUNT PLACE
- CLARIDGE CLOSE  
CLEMATIS CLOSE  
CLIFTON PLACE  
COLLEEN CLOSE  
COPPERLEAF PLACE,  
CHERRYBROOK NOT THE  
CASTLE HILL ADDRESS  
COPPLESTONE PLACE  
CORAL COURT  
CORNHILL PLACE  
COUNTY DRIVE  
CRESTVIEW PLACE
- D** DALKEITH ROAD  
DANIEL CLOSE  
DANTIC PLACE  
DAPHNE CLOSE  
DARLINGTON DRIVE  
DAVID ROAD  
DAWES PLACE  
DE LA SALLE PLACE  
DINMORE PLACE  
DOULTON DRIVE  
DOVER COURT  
DUER PLACE  
DUNKELD PLACE  
DUNLEY PLACE  
DUNRAVEN WAY
- E** EARLS COURT  
ELABANA CRESCENT  
ELABANA WAY  
ELEANOR WAY  
ELRIDGE STREET  
ELLIMATTA WAY  
ELLIOTT PLACE  
ERLESTROKE PLACE  
ERYNE PLACE
- F** FALLON DRIVE  
FEATHERWOOD AVENUE  
FERNBANK PLACE  
FERNBROOK PLACE  
FERNLEIGH CLOSE  
FOLEY PLACE  
FOLKSTONE PLACE  
FOREST CLOSE  
FOREST GLEN  
FORESTER CRESCENT  
FOXWOOD WAY  
FRANCIS GREENWAY DR  
FRANKLIN ROAD
- G** GAVIN PLACE  
GHISLA CLOSE
- GLENOAK WAY  
GLENOWEN WAY  
GLEN TREES PLACE  
GOODMAN PLACE  
GOLDEN GROVE  
GLAMORGAN WAY  
GLEN ROAD  
GREYWOOD STREET  
GROVEWOOD PLACE  
GUMNUT PLACE  
GUMNUT ROAD  
GWYNELLEN PLACE
- H** HADLEY COURT  
HALLAM WAY  
HALLEN ROAD  
HAMPSHIRE COURT  
HANCOCK DRIVE  
HARCOURT PLACE  
HARLECH COURT  
HARTREE PLACE  
HAVEN COURT  
HAWKESWORTH PLACE  
HAWKESWORTH PLACE  
HAWTHORN PLACE  
HAYLEY PLACE  
HERITAGE COURT  
HIBISCUS PLACE  
HICKORY PLACE  
HIGHBROOK PLACE  
HIGHCLERE PLACE  
HIGHGATE PLACE  
HILLGATE AVENUE  
HILLOAK COURT  
HILLSBOROUGH CT  
HOLCROFT PLACE  
HOLLY ROAD  
HOYA PLACE
- I** ISABEL CLOSE  
IVY PLACE
- J** JAMES HENRY DRIVE  
JANICE PLACE  
JENNER ROAD  
JENNIFER PLACE  
JOANNE CLOSE  
JOHN ROAD  
JOHN RADLEY AVE  
JONATHAN PLACE  
JOSEPHINE CRESCENT  
JOYCE PLACE  
JULIANA WAY
- K** KAFFIR CLOSE  
KANANGRA CRESCENT
- KATE PLACE  
KAY CLOSE  
KAYLA WAY  
KEIGHRAN PLACE  
KEITH COURT  
KENBURN AVENUE  
KENNETH PLACE  
KENTIA PARADE  
KINGSCOTT PLACE  
KRISTINE PLACE
- L** LAMBE PLACE  
LAUREN PLACE  
LEMONGRASS PLACE  
LONGWORTH CRESCENT  
LOUISE WAY  
LYDHAM PLACE  
LYNDHURST WAY  
LYONS PLACE
- M** MCCUSKER CRES  
MACQUARIE DRIVE  
MCKINLEY PLACE  
MAHOGANY COURT  
MANUKA CIRCLE  
MARIAM PLACE  
MARK PLACE  
MARY ANNE PLACE  
MELISSA PLACE  
MELIA COURT  
MENSA PLACE  
MERRIWA PLACE  
MILFORD GROVE  
MILLBROOK PLACE  
MIRANDA CLOSE  
MIRIAM CLOSE  
MONTEREY PLACE  
MORE PLACE  
MOWBRAY CLOSE  
MURRELL PLACE
- N** NADINE CLOSE  
NAOMI COURT  
Part of NEW LINE ROAD  
(145-209; 150-214)  
NICHOLI PLACE  
NIXON PLACE  
NORMAN HALL CLOSE  
NORTHCOTT WAY  
NORWICH PLACE  
NORTHWOOD WAY
- O** OAKHILL DRIVE  
OAKLEA WAY  
ODNEY PLACE  
OLIVER WAY
- OLIE PLACE  
ORION CLOSE  
OWEN WAY
- P** PARKHILL CRESCENT  
PARKWOOD CLOSE  
PATRICIA PLACE  
PATU PLACE  
PECAN CLOSE  
PEDIT PLACE  
PENROSE AVENUE  
PHILIP PLACE  
PHOENIX CLOSE  
PINEVIEW PLACE  
POGSON DRIVE  
PROTEA PLACE  
PURCHASE ROAD  
PYKETT PLACE
- R** REBECCA PLACE  
RICHMOND COURT  
RIGEMONT CLOSE  
RIDGEVIEW WAY  
RIDGEWOOD PLACE  
RIMU STREET  
ROBERT ROAD  
ROCHFORD WAY  
ROSEMARY PLACE  
ROMEOP PLACE  
ROSLYN PLACE  
ROSSIAN PLACE  
ROTHBURY PLACE  
ROWENA PLACE  
RUTH PLACE
- S** SALVIA PLACE  
SCARBOROUGH WAY  
SELINA PLACE  
SHEOAK CLOSE  
SHEPHERDS DRIVE  
SPRINGTHORPE WAY  
STANIER CLOSE  
STIRLING COURT
- T** TAHLEE CLOSE  
TALINGA PLACE  
TALLOWOOD AVENUE  
TAMARISK CRESCENT  
TANBARK PLACE  
TANLEE CLOSE  
TAWMII PLACE  
TEAK PLACE  
TEDDICK PLACE
- TENNYSON CLOSE  
THOMAS WILKINSON AVE  
THORPE AVE  
TIMOTHY CLOSE  
TODD PLACE  
TOORAK COURT  
TORRENS PLACE  
TREETOP'S ROAD  
TREVORS LANE  
TUDOR AVENUE  
TUNBRIDGE PLACE  
TUSCAN WAY
- V** VERINCOURT WAY  
VERONICA PLACE
- W** WALNUT GROVE  
WATTS PLACE  
WEAVER PLACE  
WESLEY PLACE  
WESTMINSTER DRIVE  
WETSTONE WAY  
WHIPBIRD PLACE  
WHITBAR WAY  
WILFLOWER PLACE  
WILDWOOD WAY  
WILLOWBROOK PLACE  
WILTSHIRE COURT  
WINDSOR COURT  
WINDEMERE GARDENS  
WISTERIA CRESCENT  
WOOD GLEN PLACE  
WOODGROVE AVENUE  
WOODLARK PLACE  
WOODRUSH COURT  
WORTHING PLACE  
WREN COURT  
WYLLIE PLACE
- Y** YANDERRA GROVE  
YOORANA PLACE
- Z** ZULFI PLACE





**Cherrybrook Technology High School  
2023**